



“

2014 9 10

—

13.

”

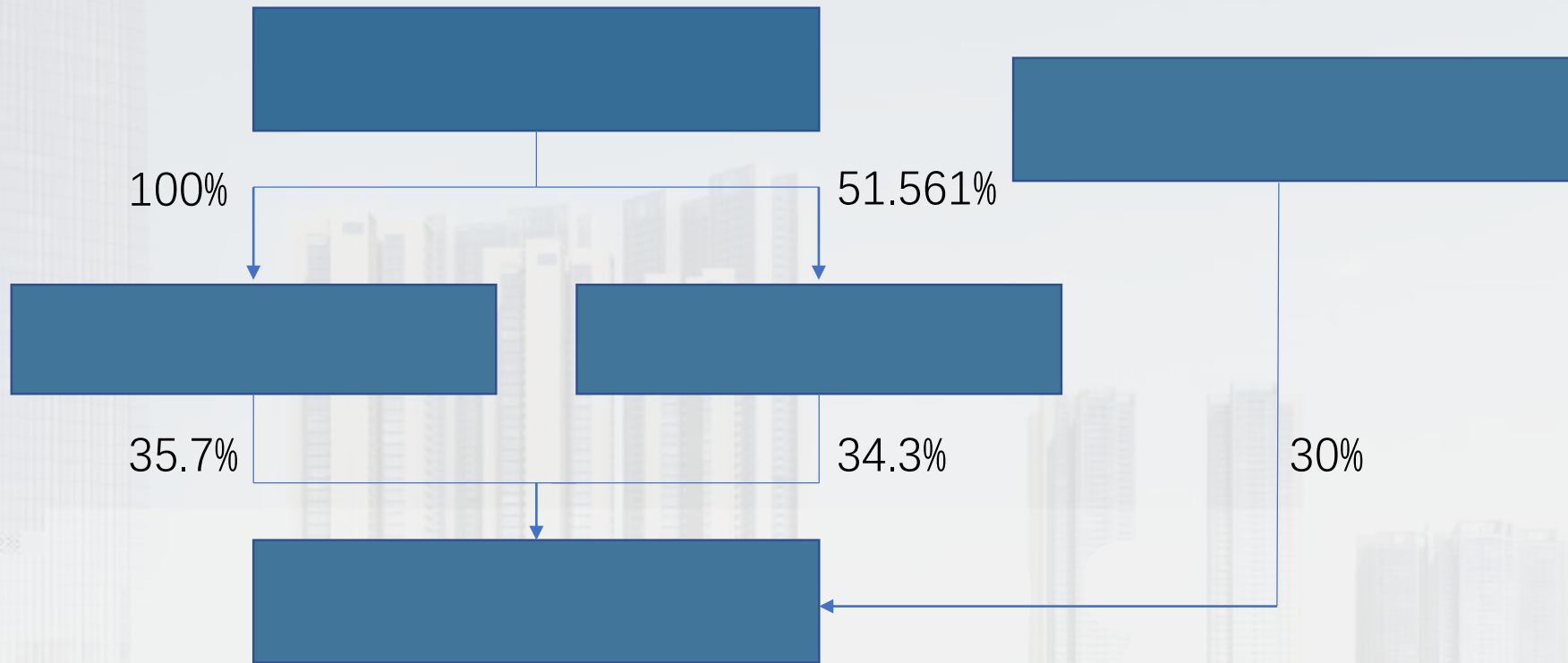



CBD

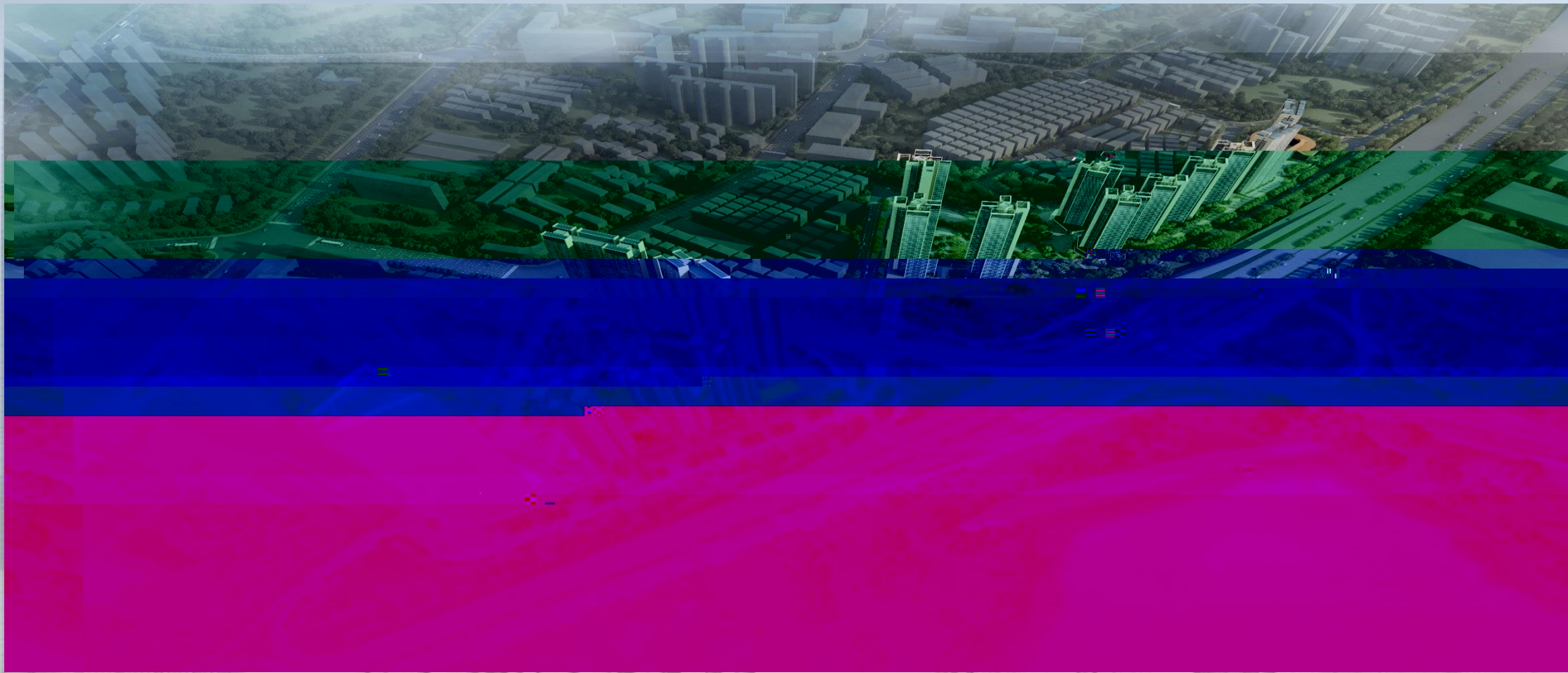

41820	96000	490265.77	245603	910	4800
937	1975.77m ²	112000	78000	34460	2019
	10600	126			

116744m² (
41820m²) 74924
m² 4000m²
4800m²

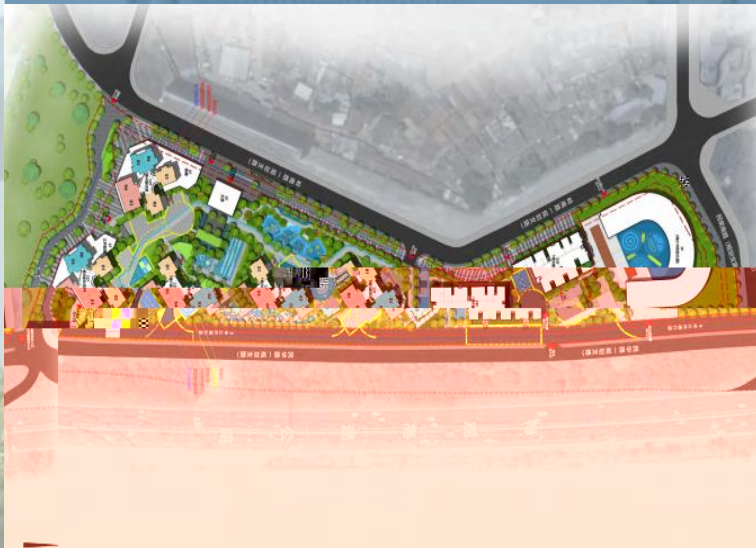

65859m², 1000m²



63000m² 29460m²
78000m²
112000m²



● 2019 11 30

● 2020 11 30

● 2022 11 30

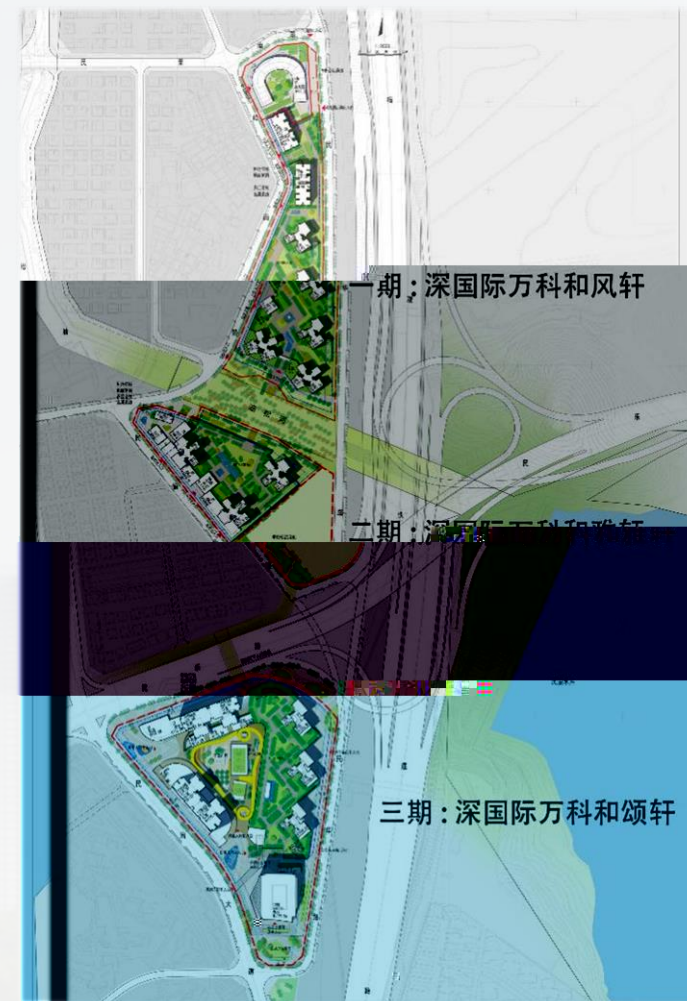

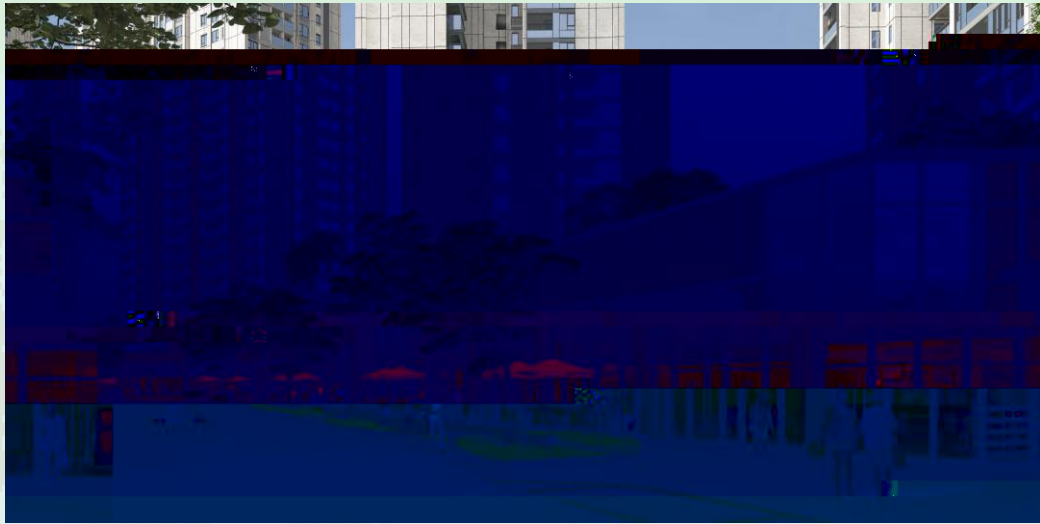



*Aî,´

Ã

4



龙华新区民治办事处梅林关更新单元项目

代建合同

甲 方：深圳市深国际联合置地有限公司

乙 方：万科企业股份有限公司

签订日期： 2017 年 10 月

合同编号： _____

2017 10

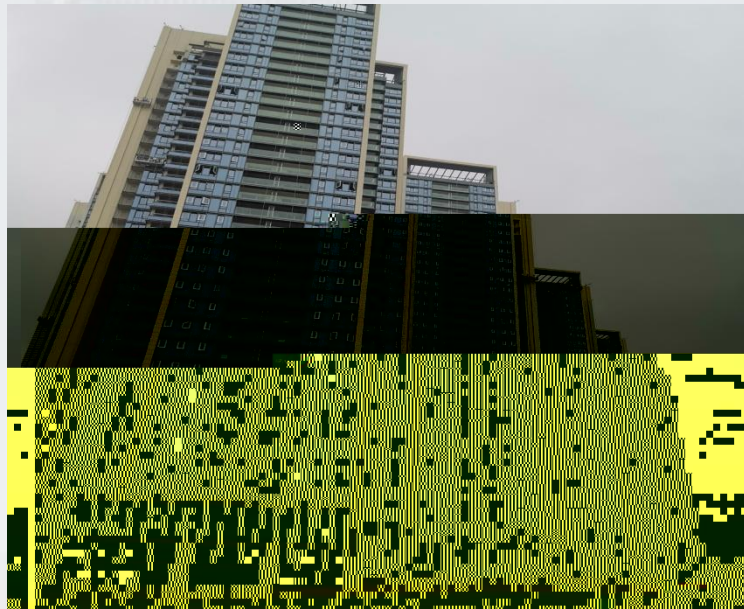

95%



1 A
1 B
2

18
17
25



80%

- 2014

2015 6 22

-2018 6 21

-2018 9 11

2019

2019

2019 4

2019

安全生产示范工地

深圳市龙华区住房和建设局

